

# Listwa T100 – montaż wariant 1

1.

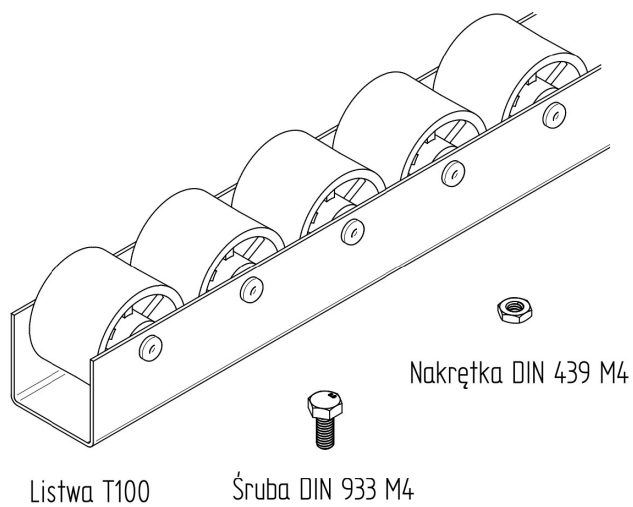

2.

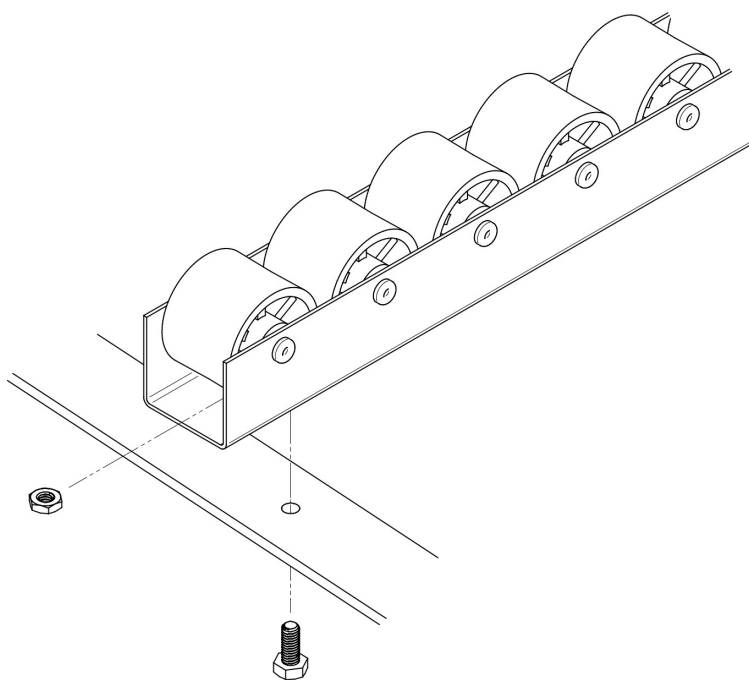

3.

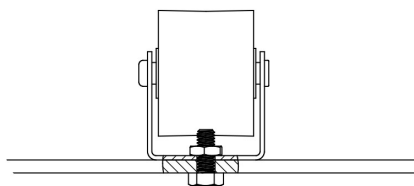

# Listwa T100 – montaż wariant 2

1.

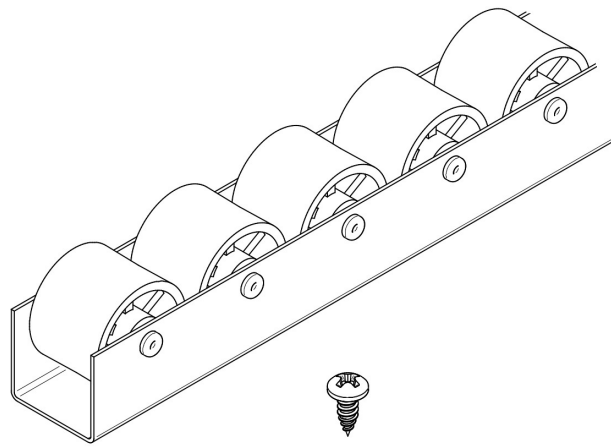

Listwa T100

Blachowkręt ST4,8

2.

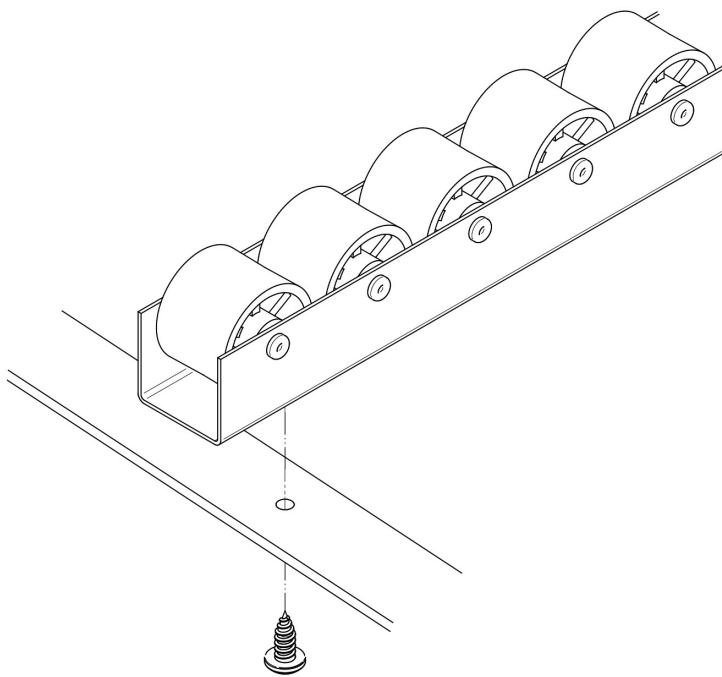

3.

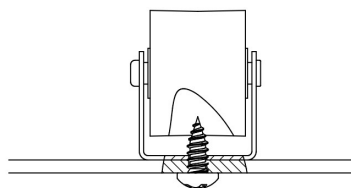

# Listwa T100 – montaż wariant 3

1.

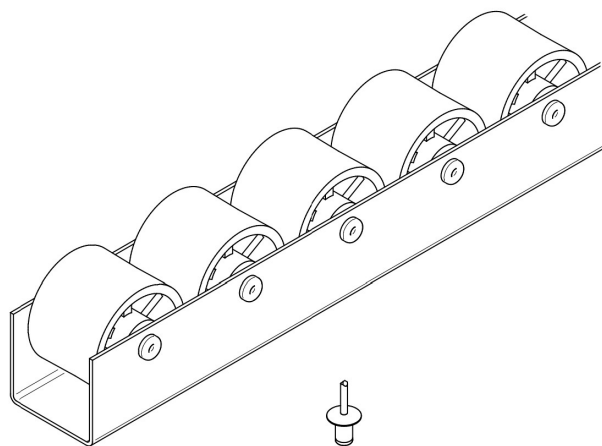

Listwa T100

Nit zrywalny fi4

2.

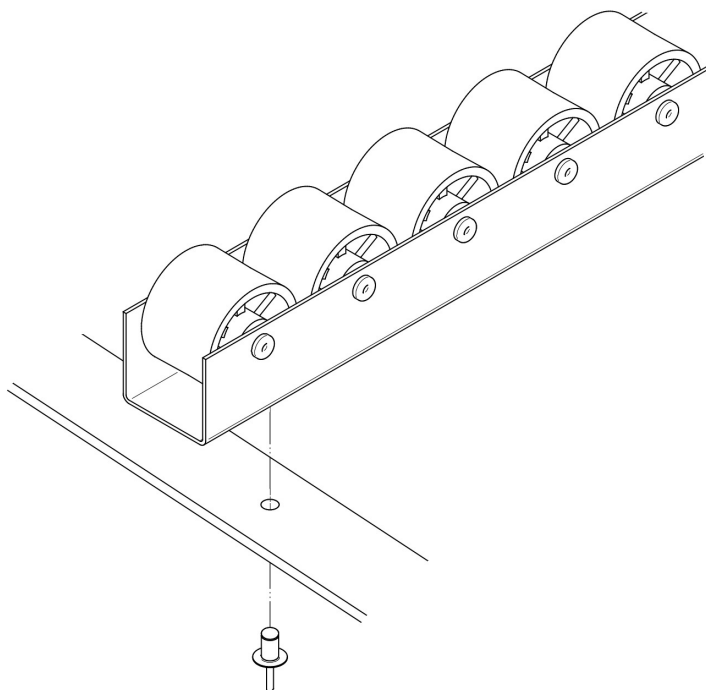

3.

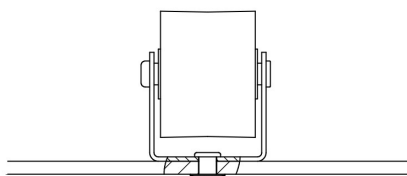

# Listwa T100 – montaż wariant 4

1.

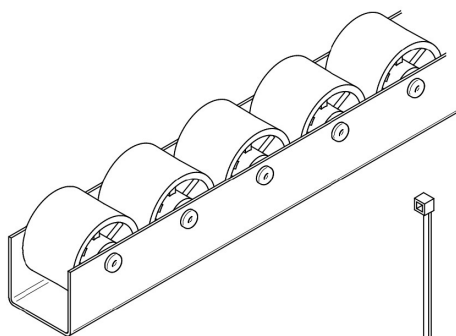

Listwa T100

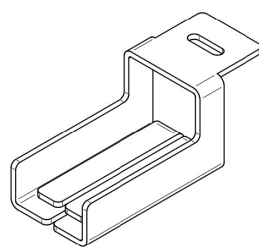

Uchwyt typ 100, 610

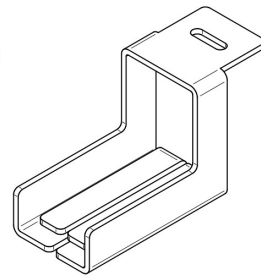

Uchwyt STOP typ 100, 610

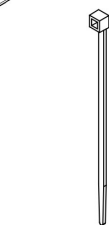

2 x Opaska kablowa

2.

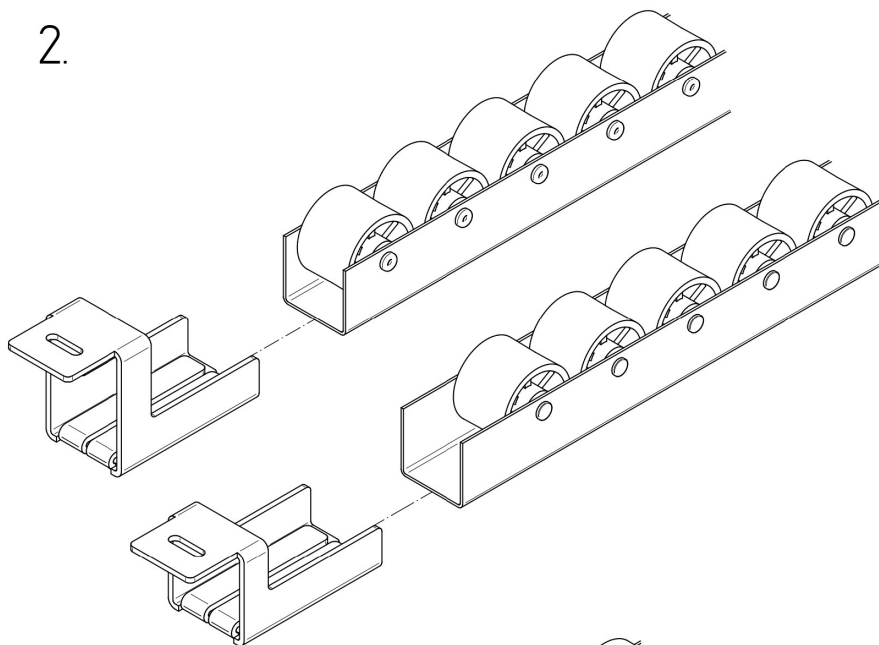

3.

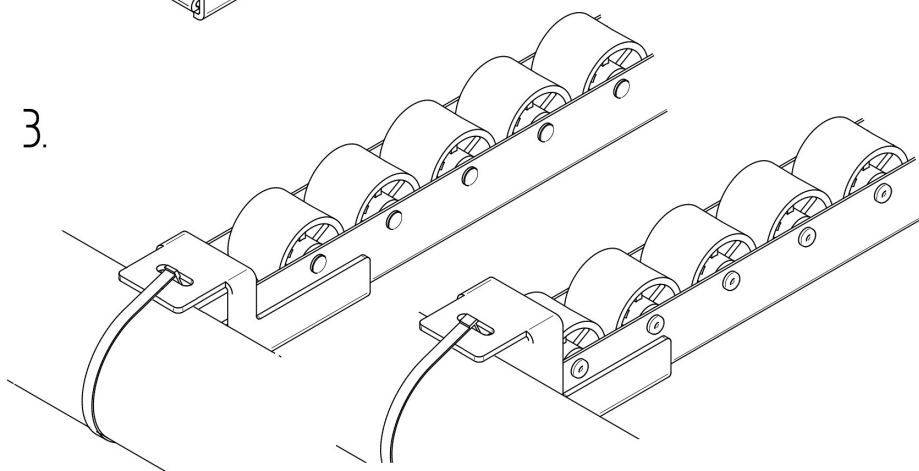

# Listwa T100 – montaż wariant 5

1.

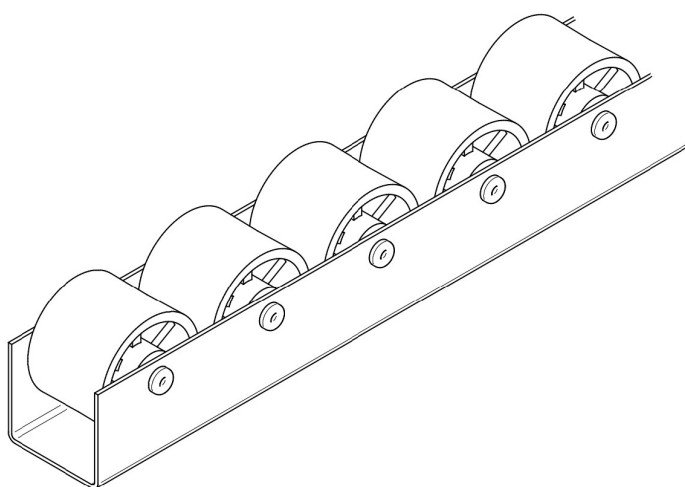

Listwa T100

2.

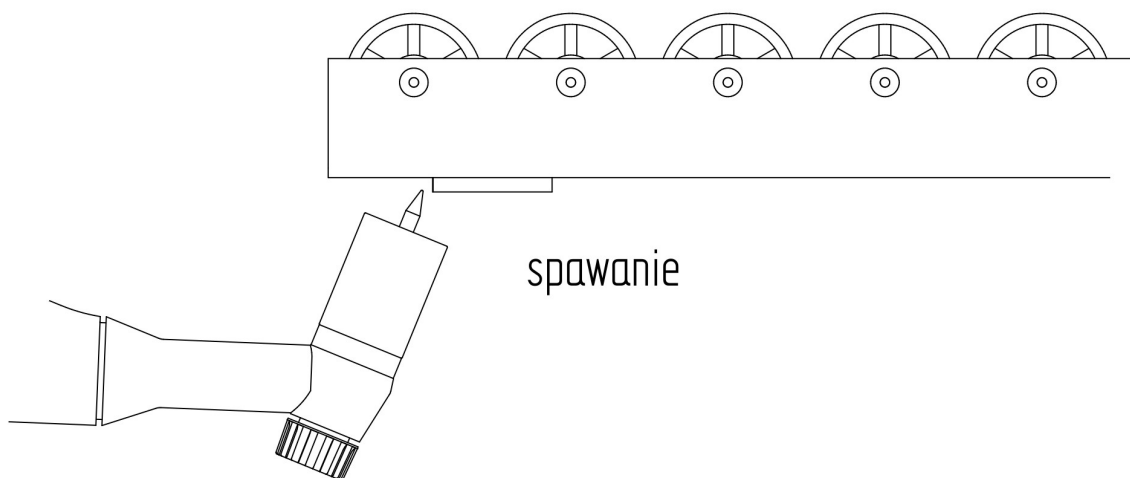

Rolki należy schłodzić bezpośrednio po spawaniu